



**COMMONWEALTH OF KENTUCKY  
TRANSPORTATION CABINET**  
Frankfort, Kentucky 40622  
[www.transportation.ky.gov/](http://www.transportation.ky.gov/)

**Matthew G. Bevin**  
Governor

**Greg Thomas**  
Secretary

August 18, 2016

CALL NO. 106  
CONTRACT ID NO. 161041  
ADDENDUM # 1

Subject: Perry County, NHPP 0805 (024)  
Letting August 26, 2016

- (1) Revised - General Summary - Pages 19-20 of 157
- (2) Revised - Drawing - Pages 32-37 of 157
- (3) Revised - Bid Items - Pages 156-157 of 157

Proposal revisions are available at <http://transportation.ky.gov/Construction-Procurement/>.

If you have any questions, please contact us at 502-564-3500.

Sincerely,

A handwritten signature in cursive script that reads "Rachel Mills".

Rachel Mills, P.E.  
Director  
Division of Construction Procurement

RM:ks  
Enclosures



An Equal Opportunity Employer M/F/D

## GENERAL SUMMARY

ITEM CODE	ITEM	UNIT					PROJECT TOTAL
462	CULVERT PIPE - 18 IN	L.F.					117
1204	PIPE CULVERT HEADWALL - 18 IN	EACH					2
1608	CONC. MED. BARR. BOX INLET TYPE 12-B1	EACH					2
1982	DELINEATOR FOR GUARDRAIL-MW	EACH					5
1984	DELINEATOR FOR BARRIER WALL - M/W	EACH					48
1986	DELINEATOR FOR BARRIER WALL - B/Y (5)	EACH					15
2003	RELOCATE TEMP CONC BARRIER	L.F.					4800
2014	BARRICADE TYPE III	EACH					3
2115	SAW-CLEAN-RESEAL TRAVERSE JOINT (4)	L.F.					730
2381	REMOVE GUARDRAIL	L.F.					150
2484	CHANNEL LINING CLASS III	TON					28
21802EN	G/R STEEL BEAM -S FACE (7 FT POST)	L.F.					150
2562	TEMPORARY SIGNS	S.F.					350
2568	MOBILIZATION	L.S.					1
2569	DEMOBILIZATION	L.S.					1
2575	DITCHING AND SHOULDERING (2)	L.F.					500
2585	EDGE KEY	L.F.					96
2600	FABRIC-GEOTEXTILE TYPE IV FOR PIPE	SQ. YD.					105
2650	MAINTAIN & CONTROL TRAFFIC	L.S.					1
2654	TRUCK MOUNTED ATTENUATOR	EACH					2
2671	PORTABLE CHANGEABLE MESSAGE SIGN	EACH					3
2695	RUMBLE STRIPS TYPE III	L.F.					150
2726	STAKING (3)	L.S.					1
2775	ARROW PANEL	EACH					2
2898	RELOCATE CRASH CUSHION	EACH					3
2998	MASONRY COATING	SQ. YD.					890
3171	CONCRETE BARRIER WALL TYPE 9T	L.F.					4800
6510	PAVE STRIPING-TEMP PAINT-4 IN	L.F.					12215
6514	PAVE STRIPING-PERM PAINT-4 IN	L.F.					12215
6546	PAVE STRIPING - THERMO-12 IN W (6) (7)	L.F.					1805
6547	PAVE STRIPING - THERMO-12 IN Y (6)	L.F.					500
6549	PAVE STRIPING - TEMP REM TAPE - B (2)	L.F.					2000
6550	PAVE STRIPING - TEMP REM TYPE - W (2)	L.F.					2000
6551	PAVE STRIPING - TEMP REM TYPE - Y (2)	L.F.					2000
6600	REMOVE PAVEMENT MARKER TYPE V	EACH					180
10020NS	FUEL ADJUSTMENT	DOLLAR					2574
22883EN	CONCRETE WEDGE CURB	L.F.					150
24489EC	INLAID PAVEMENT MARKER	EACH					269
23143ED	KPDES PERMIT AND TEMP E.C.	L.S.					1

ITEM CODE	ITEM	UNIT					PROJECT TOTAL
24640ED	OBJECT MARKER TYPE 1	EACH					4
23979EC	CRASH CUSHION TYPE VI CLASS C TL3	EACH					2
22664EN	WATER BLASTING EXISTING STRIPE	L.F.					12215
20411ED	LAW ENFORCEMENT OFFICER (1)	HOUR					500
24868EC	REMOVE ROCK SUBGRADE	SQ. YD.					17233
20738NS112	TEMP CRASH CUSHION	EACH					2
	(1) KENTUCKY STATE POLICE						
	(2) AT LOCATIONS AS DIRECTED BY THE ENGINEER						
	(3) SEE SPECIAL NOTE FOR STAKING						
	(4) REMOVE AND REPLACE EXISTING SHOULDER JOINT SEAL						
	(5) FOR BARRIER WALLS 50" OR LESS IN HEIGHT, DEALINEATORS MAY BE INSTALLED ON TOP OF THE BARRIER WALL.						
	(6) INCLUDED AN ADDITIONAL 500 FT TO BE USED AT LOCATIONS AS DIRECTED BY THE ENGINEER						
	(7) 1305 FT TO BE USED AT THE GORE AREAS						

3236+00

3237+00

3238+00

3239+00

3240+00

3241+00

PHASE 2B  
END OF BARRIER WALL  
STATION 3241+00

M.P. 8.1

TEMP BARRIER WALL

PHASE 1

PHASE 2A

TEMP CRASH CUSHION

CONSTRUCT RAMP  
DIVERSION

PHASE 1

SEE STANDARD DRAWINGS AND MUTCD FOR PLACEMENT OF TEMPORARY SIGNS, TEMPORARY STRIPING, PORTABLE CHANGEABLE MESSAGE SIGNS, BARRICADES, BARRELS AND OTHER TEMPORARY TRAFFIC CONTROL DEVICES. LOCATION OF ALL TEMPORARY TRAFFIC CONTROL DEVICES TO BE APPROVED BY THE CONSTRUCTION ENGINEER.  
INSTALL TEMPORARY TRAFFIC CONTROL DEVICES ON KY 80 ON-RAMP AND MAINLINE KY 80.  
MAINTAIN TRAFFIC ON EXISTING LANES WHILE CONSTRUCTING TEMPORARY DIVERSION ON KY 80 ON-RAMP.

MOT  
PHASE I

DRAWING NOT TO SCALE

ITEM # 10-2025

PHASE II

MOVE ON-RAMP TRAFFIC TO NEWLY CONSTRUCTED RAMP DIVERSION.  
CONSTRUCT PHASE 2A, CLOSE EASTBOUND OUTSIDE LANE AND SHOULDER FROM ON-RAMP (APPROX. STA. 3239+00) TO STATION 3254+00.

APPLY TEMPORARY PAVEMENT MARKINGS AS DETAILED ON THE STANDARD DRAWING "LANE CLOSURE MULTI-LANE HIGHWAY CASE II", TTC-120-03

INSTALL DRAINAGE PIPES AND HEADWALLS AND REMOVE AND INSTALL CONCRETE PAVEMENT ON THE EASTBOUND OUTSIDE TRAFFIC LANES AND SHOULDERS.

MOVE ON-RAMP TRAFFIC TO NEWLY CONSTRUCTED ON-RAMP PAVEMENT AND EASTBOUND OUTSIDE LANE.

CONSTRUCT OFF-RAMP TEMP. PAVEMENT WIDENING.  
CLOSE OTHER SECTIONS OF OUTSIDE LANES AND SHOULDERS AND APPLY TEMPORARY TRAFFIC CONTROLS.  
INSTALL DRAINAGE PIPES AND HEADWALLS AND REMOVE AND INSTALL CONCRETE PAVEMENT.

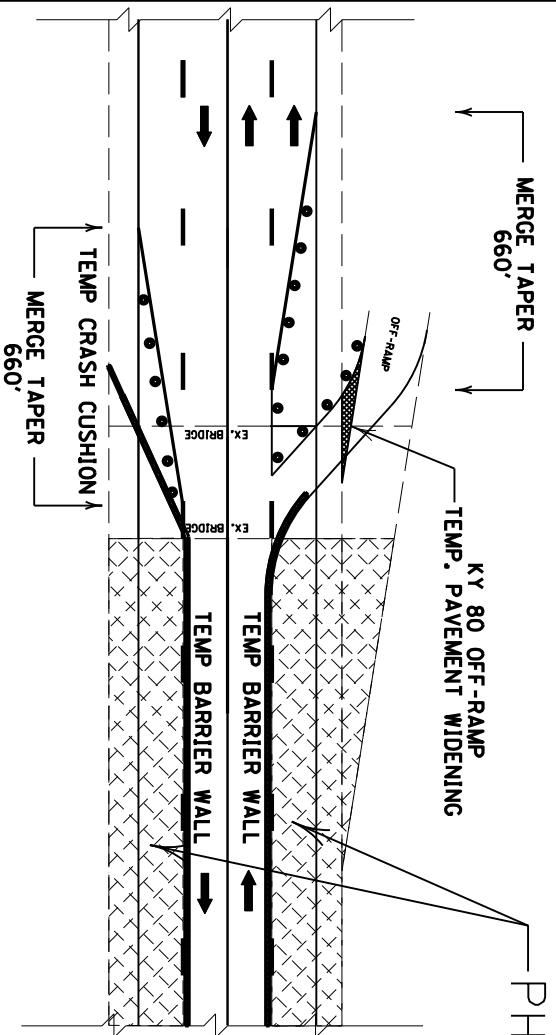

PHASE 2B

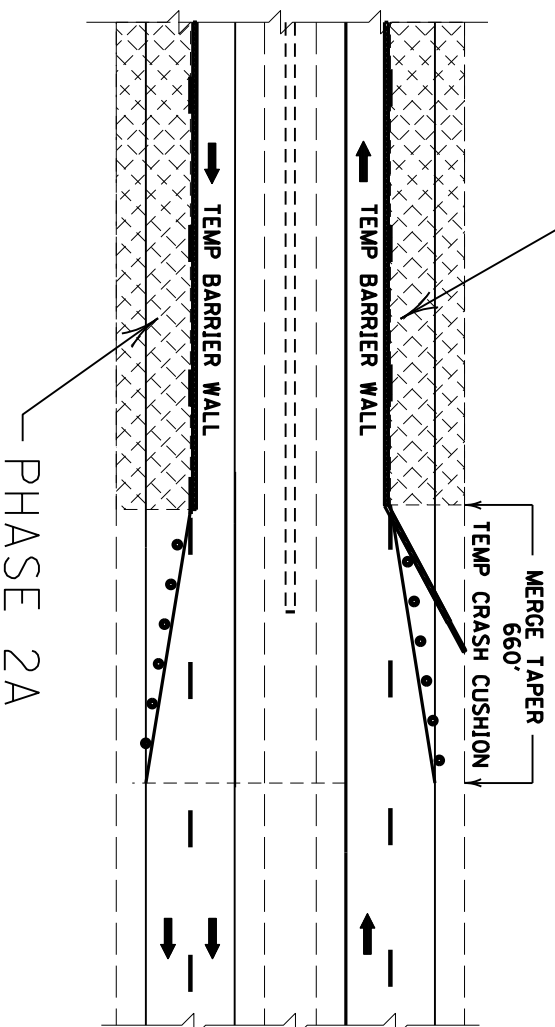

PHASE 2A

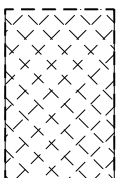

CONSTRUCT THIS PHASE

DRAWING NOT TO SCALE

MOT  
PHASE II

ITEM # 10-2025



REVISED ADDENDUM 1: 8/18/16  
PHASE III  
SHIFT TRAFFICS TO THE NEWLY CONSTRUCTED OUTSIDE TRAFFIC LANES.  
CLOSE INSIDE TRAFFIC LANES AND SHOULDERS.

APPLY TEMPORARY PAVEMENT MARKINGS AS DETAILED ON THE STANDARD DRAWING "LANE CLOSURE MULTI-LANE HIGHWAY CASE II", TTC-120-03  
INSTALL DRAINAGE STRUCTURES AND REMOVE AND INSTALL CONCRETE PAVEMENT ON THE INSIDE TRAFFIC LANES AND SHOULDERS.

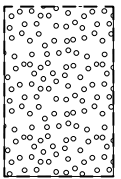
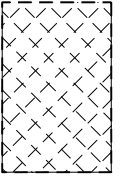
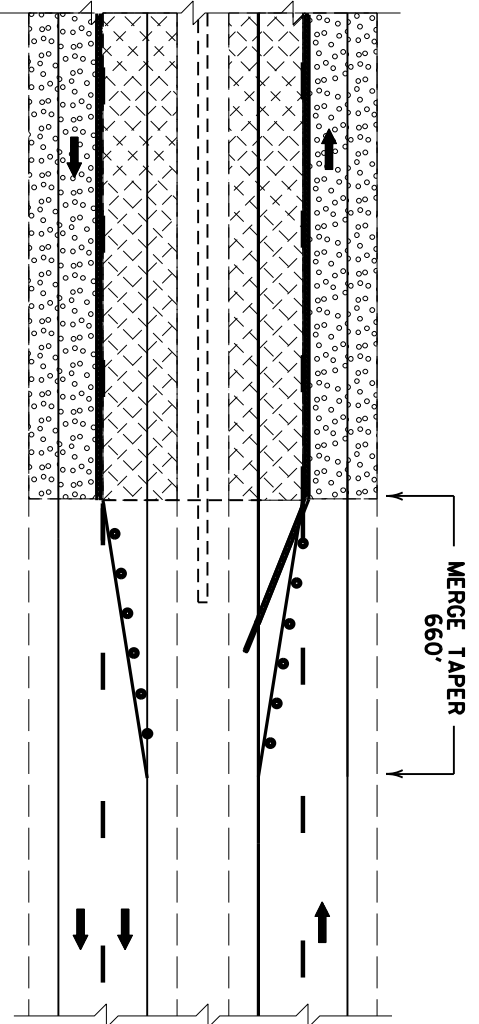
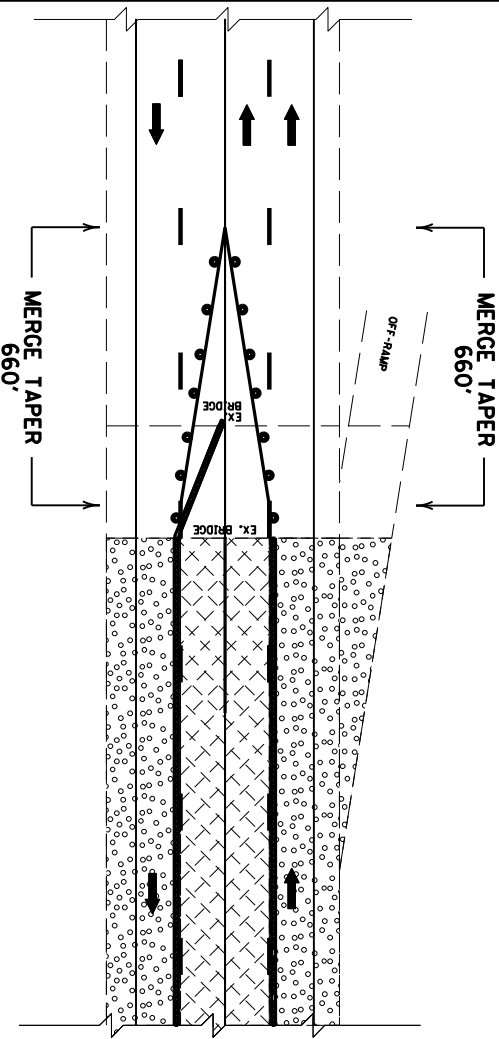

CONSTRUCT THIS PHASE

PREVIOUSLY CONSTRUCTED

DRAWING NOT TO SCALE

MOT  
PHASE III

ITEM # 10-2025

REVISED ADDENDUM 1: 8/18/16

**WESTBOUND LANES**

86'

**EASTBOUND LANES**

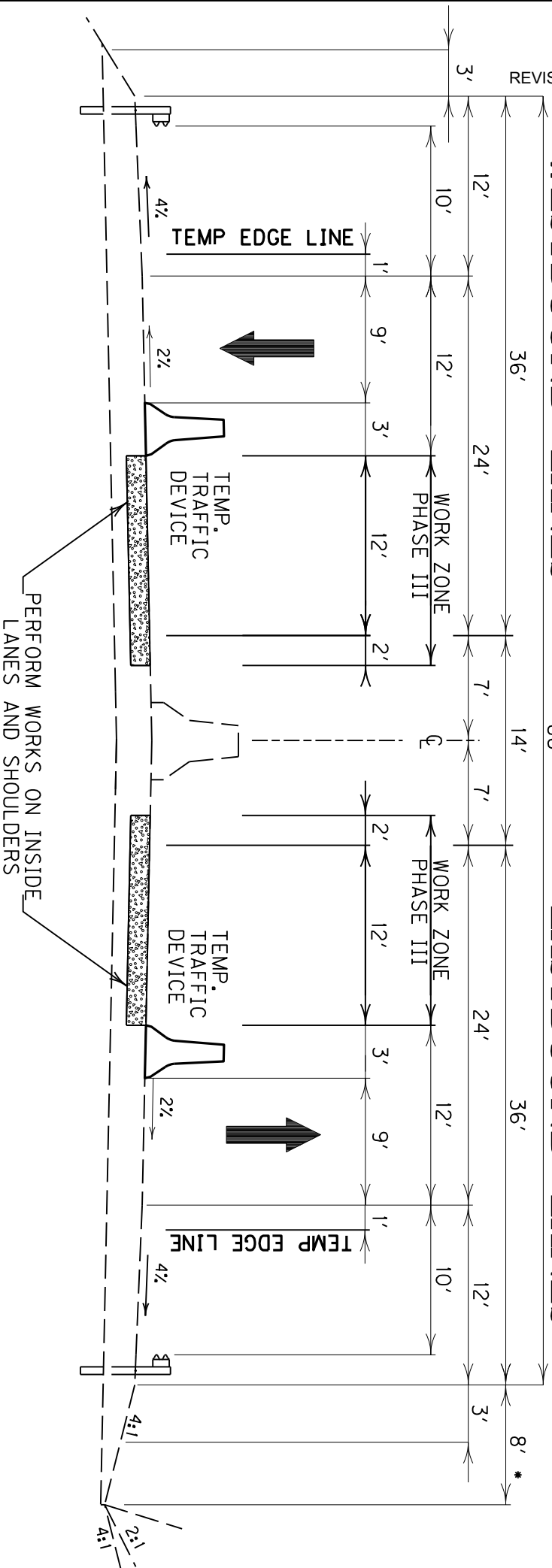

**PHASE III**

DRAWING NOT TO SCALE



PHASE IV

REMOVE ALL TEMPORARY PAVEMENT MARKINGS AND INSTALL PERMANENT PAVEMENT MARKERS.

RESTORE ALL PERMANENT PAVEMENT MARKINGS.

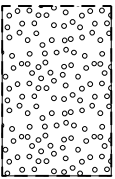
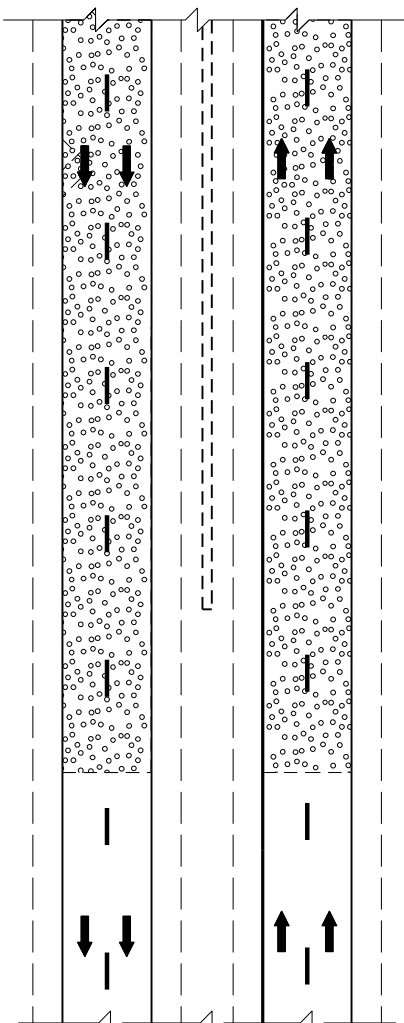
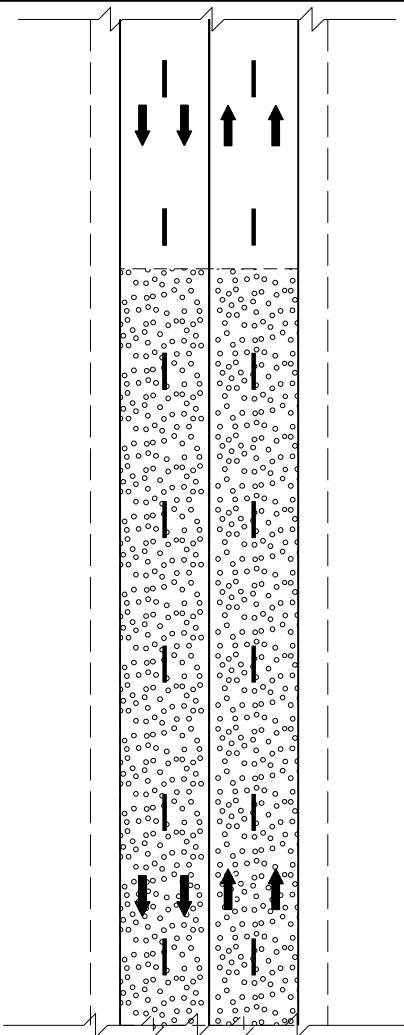

PREVIOUSLY CONSTRUCTED

MOT  
PHASE IV

ITEM # 10-2025

**PROPOSAL BID ITEMS**

REVISED ADDENDUM 1: 8/18/16

Page 1 of 2

161041

Report Date 8/18/16

**Section: 0001 - PAVING**

LINE	BID CODE	ALT	DESCRIPTION	QUANTITY	UNIT	UNIT PRIC	FP	AMOUNT
0010	00001		DGA BASE	4,099.00	TON		\$	
0020	00100		ASPHALT SEAL AGGREGATE	14.00	TON		\$	
0030	00103		ASPHALT SEAL COAT	2.00	TON		\$	
0040	00194		LEVELING & WEDGING PG76-22	237.00	TON		\$	
0050	00387		CL3 ASPH SURF 0.38B PG76-22	336.00	TON		\$	
0060	02058		REMOVE PCC PAVEMENT	17,233.00	SQYD		\$	
0070	02086		JPC PAVEMENT-13 IN	17,233.00	SQYD		\$	
0080	24868EC		REMOVE ROCK SUBGRADE	17,233.00	SQYD		\$	

**Section: 0002 - ROADWAY**

LINE	BID CODE	ALT	DESCRIPTION	QUANTITY	UNIT	UNIT PRIC	FP	AMOUNT
0090	01982		DELINEATOR FOR GUARDRAIL MONO DIRECTIONAL WHITE	5.00	EACH		\$	
0095	01984		DELINEATOR FOR BARRIER - WHITE (REVISED: 8/18/16)	48.00	EACH		\$	
0100	01986		DELINEATOR FOR BARRIER WALL-B/Y	15.00	EACH		\$	
0105	02003		RELOCATE TEMP CONC BARRIER (REVISED: 8/18/16)	4,800.00	LF		\$	
0110	02014		BARRICADE-TYPE III	3.00	EACH		\$	
0120	02115		SAW-CLEAN-RESEAL TVERSE JOINT	730.00	LF		\$	
0130	02381		REMOVE GUARDRAIL	150.00	LF		\$	
0140	02484		CHANNEL LINING CLASS III	28.00	TON		\$	
0150	02562		TEMPORARY SIGNS	350.00	SQFT		\$	
0160	02575		DITCHING AND SHOULDERING	500.00	LF		\$	
0170	02585		EDGE KEY	96.00	LF		\$	
0180	02650		MAINTAIN & CONTROL TRAFFIC	1.00	LS		\$	
0190	02654		TRUCK MOUNTED ATTENUATOR	2.00	EACH		\$	
0200	02671		PORTABLE CHANGEABLE MESSAGE SIGN	3.00	EACH		\$	
0210	02695		RUMBLE STRIPS TYPE 3	150.00	LF		\$	
0220	02726		STAKING	1.00	LS		\$	
0230	02775		ARROW PANEL	2.00	EACH		\$	
0235	02898		RELOCATE CRASH CUSHION (REVISED: 8/18/16)	3.00	EACH		\$	
0240	02998		MASONRY COATING	890.00	SQYD		\$	
0245	03171		CONCRETE BARRIER WALL TYPE 9T (REVISED: 8/18/16)	4,800.00	LF		\$	
0250	06510		PAVE STRIPING-TEMP PAINT-4 IN	12,215.00	LF		\$	
0260	06514		PAVE STRIPING-PERM PAINT-4 IN	12,215.00	LF		\$	
0270	06546		PAVE STRIPING-THERMO-12 IN W	1,805.00	LF		\$	
0280	06547		PAVE STRIPING-THERMO-12 IN Y	500.00	LF		\$	
0290	06549		PAVE STRIPING-TEMP REM TAPE-B	2,000.00	LF		\$	
0300	06550		PAVE STRIPING-TEMP REM TAPE-W	2,000.00	LF		\$	
0310	06551		PAVE STRIPING-TEMP REM TAPE-Y	2,000.00	LF		\$	
0320	06600		REMOVE PAVEMENT MARKER TYPE V	180.00	EACH		\$	
0330	10020NS		FUEL ADJUSTMENT	2,574.00	DOLL	\$1.00	\$	\$2,574.00
0340	20411ED		LAW ENFORCEMENT OFFICER	500.00	HOUR		\$	

**PROPOSAL BID ITEMS**

REVISED ADDENDUM 1: 8/18/16

161041

Page 2 of 2

Report Date 8/18/16

LINE	BID CODE	ALT	DESCRIPTION	QUANTITY	UNIT	UNIT PRIC	FP	AMOUNT
0345	20738NS112		TEMP CRASH CUSHION (REVISED: 8/18/16)	2.00	EACH		\$	
0350	21802EN		G/R STEEL W BEAM-S FACE (7 FT POST)	150.00	LF		\$	
0360	22664EN		WATER BLASTING EXISTING STRIPE	12,215.00	LF		\$	
0370	22883EN		CONCRETE WEDGE CURB	150.00	LF		\$	
0380	23143ED		KPDES PERMIT AND TEMP EROSION CONTROL	1.00	LS		\$	
0390	23979EC		CRASH CUSHION TY VI CLASS C TL3	2.00	EACH		\$	
0400	24489EC		INLAID PAVEMENT MARKER	269.00	EACH		\$	
0410	24640ED		OBJECT MARKER TYPE 1 (REVISED: 8/18/16)	4.00	EACH		\$	

**Section: 0003 - DRAINAGE**

LINE	BID CODE	ALT	DESCRIPTION	QUANTITY	UNIT	UNIT PRIC	FP	AMOUNT
0420	00462		CULVERT PIPE-18 IN	117.00	LF		\$	
0430	01204		PIPE CULVERT HEADWALL-18 IN	2.00	EACH		\$	
0440	01608		CONC MED BARR BOX INLET TY 12B1	2.00	EACH		\$	
0450	02600		FABRIC GEOTEXTILE TY IV FOR PIPE	105.00	SQYD	\$2.00	\$	\$210.00

**Section: 0004 - DEMOBILIZATION &/OR MOBILIZATION**

LINE	BID CODE	ALT	DESCRIPTION	QUANTITY	UNIT	UNIT PRIC	FP	AMOUNT
0460	02568		MOBILIZATION	1.00	LS		\$	
0470	02569		DEMOBILIZATION	1.00	LS		\$	